

NOTE: Save these instructions as you may need them at a later date. For your safety, read and understand these instructions completely before starting installation. THIS PRODUCT MUST BE INSTALLED IN ACCORDANCE WITH THE APPLICABLE INSTALLATION CODE BY A PERSON FAMILIAR WITH THE CONSTRUCTION AND OPERATION OF THE PRODUCT AND THE HAZARDS INVOLVED.

CAUTION: RISK OF FIRE OR ELECTRIC SHOCK. DISCONNECT MAIN POWER AT FUSE OR CIRCUIT BREAKER BEFORE INSTALLING OR SERVICING THE FIXTURE.

- LED installation requires knowledge of luminaires electrical systems. If not qualified, do not attempt installation contact a qualified electrician.
- Before proceeding with installation, disconnect power to the luminaire. Failure to do so may result in electric shock and lead to injury or death.

Installation Instructions for 1" 12V AC Recessed Lighting:

Notice: ELCO's one inch LED fixtures are rated for direct insulation contact. For gimbal applications, it is advised for insulation set-back to prevent falling debris.

Step 1

Embr Lighting's one inch LED fixtures are designed for 120V input that is stepped down to 12V low voltage applications. For optimal fixture operation, use with Embr's 12V electronic (LET-60) transformer.

Step 2

Embr Lighting's one inch LED fixtures are adaptable to 1/4" to 1" ceiling thickness. A 2" hole size is recommended for fixed one inch LED fixtures. A 2 3/8" hole size is recommended for the adjustable one inch LED fixture. (Figure 3)

Step 3

The transformer should be installed into ceiling by two screws (attached accessory) and within 4 feet of first fixture. Follow the wiring diagram for electrical connections. MAX paralleled 6 lighting fixtures. (Figure 4 and Figure 5)

Step 4

Loosen the terminal block cover on top of the one inch LED fixture and insert the secondary leads of the 12V transformer into the adjacent terminal blocks on left of right side (Figure 1). The terminal blocks are designed to accept 18-12AWG wires. Tighten terminal block screws to secure the secondary wires. The one inch led fixture may be daisy chained using the second pair of terminal blocks.

Step 5

Route the wires back into the ceiling opening. Lift the two springs towards the terminal blocks and insert into ceiling opening. (Figure 2)

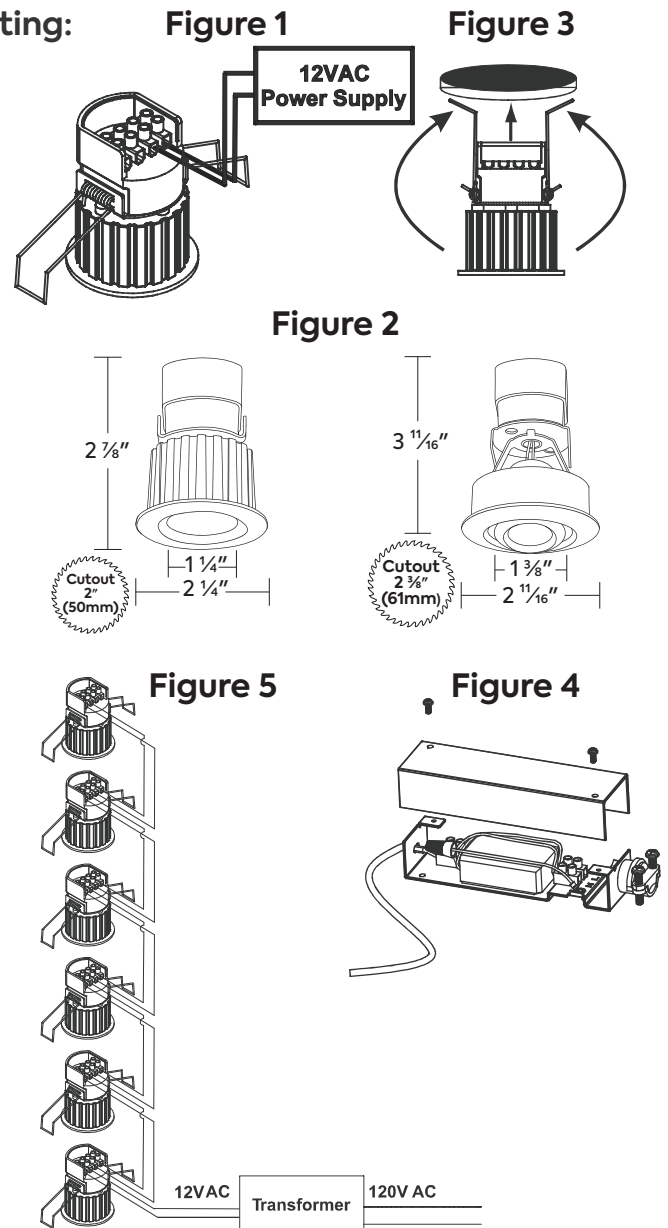

New Construction Installation:

Step 1

Extend hanger bars to fit between joists. Each hanger bar foot is contoured to align with the bottom of ceiling joists (Figure 6). Set frame into place by hammering in the nails at each foot (Figure 7).

Note: Frame can be relocated using the hammer claw which will allow easy repositioning on the fixture without damaging the hanger bar or nail (Figure 8).

Step 2

After the frame is set into place, tighten hanger bars using the locking screws mounted onto the frame. (indicated by the arrow in Figure 9).

Step 3

A precise hole is required for mounting this fixture. Cutting drywall along the inner diameter of the mounting frame will provide an accurate hole. After cutting the drywall hole, proceed from step 2 of the installation instructions.

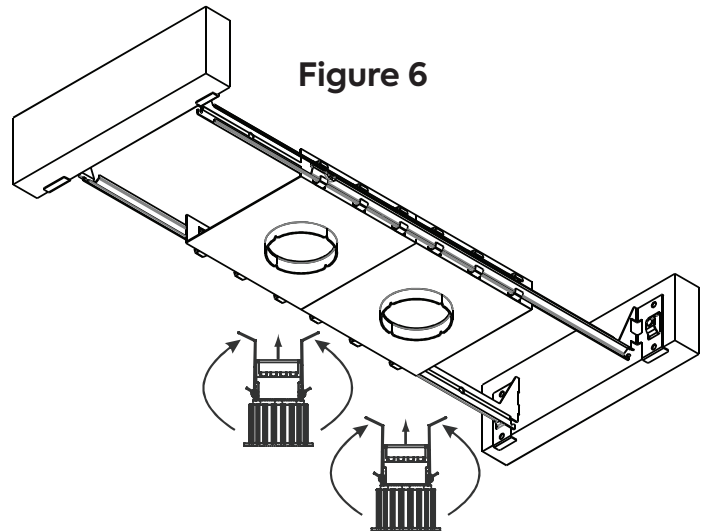

Figure 6

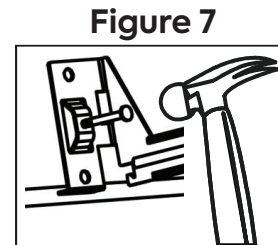

Figure 7



Figure 8

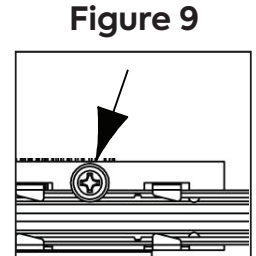

Figure 9